

Recommended P.C.B. Layout

△△ SPECIFICATION

Voltage Rating:300V AC
 Current Rating:10A/Way Max.
 △ Withstanding Voltage:2500V AC(1 Minute) Test
 Time=60s/1 Pcs
 Operation Temperature:-40°C~+105°C
 Solder Pin:Copper Alloy,Tin Plated
 Insulator Body(Housing):Polyamide+G.F.(UL94V-0),Black
 * 02~24P Available~
 RoHS Compliant

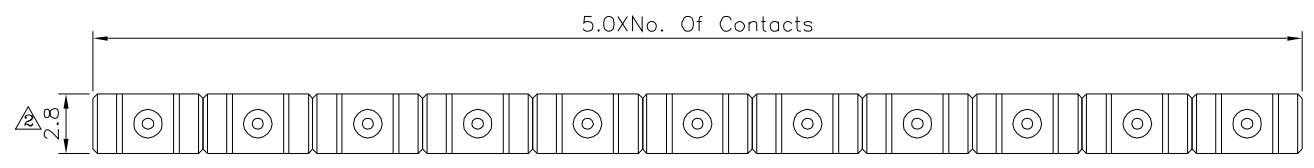

△

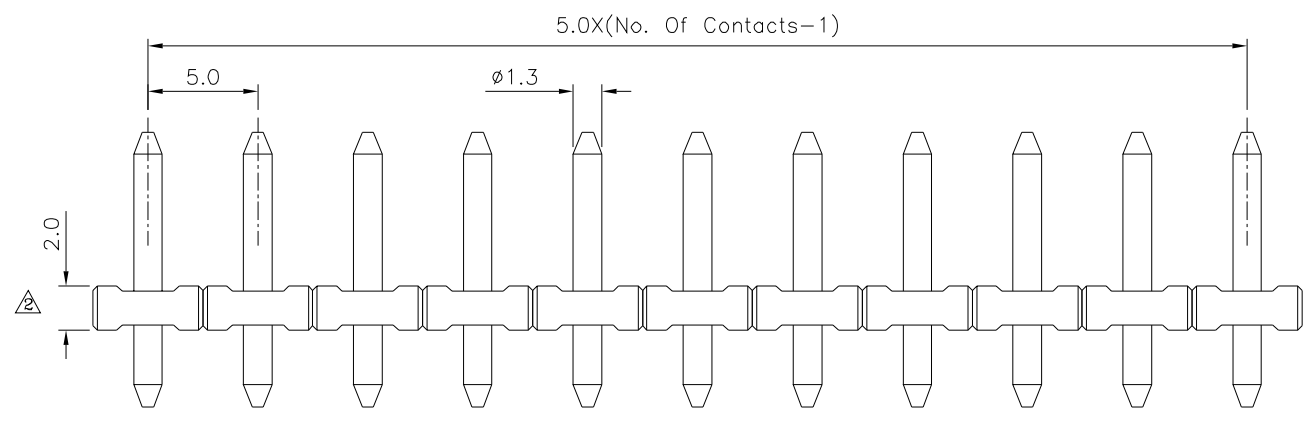

△

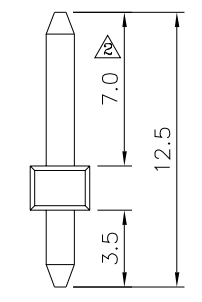

△

4UCON 元化興業股份有限公司
 4UCON TECHNOLOGY INC.

DRAWING No.		APPROVED BY		UNLESS OTHERWISE SPECIFIED TOLERANCES ARE X. ± 0.50 .X ± 0.30 .XX ± 0.20 ANG. $\pm 1^\circ$
05354		MEI		
		HZF		
SCALE		REV.		UNIT
NONE		A4		mm

△ A4	Modify Data	HZF	09/19/2023
△ A3	Modify Data	HZF	03/23/2017
△ A2	Modify Data	HZF	05/30/2013
△ A1	Modify Data	HZF	01/10/2011
△ A0	NEW RELEASE	HZF	04/29/2009
NO.REV.	REVISIONS	CHK	DATE