

**SPECIFICATION**  
 Current Rating:3A AC/DC  
 Voltage Rating:250V AC/DC  
 Temperature Range:-25°C~+85°C  
 △ Housing:PBT+15%G.F.(UL94V-0)  
 RoHS Complaint

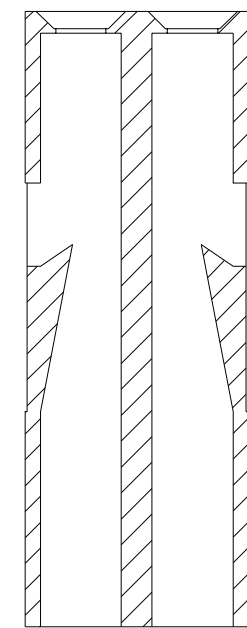
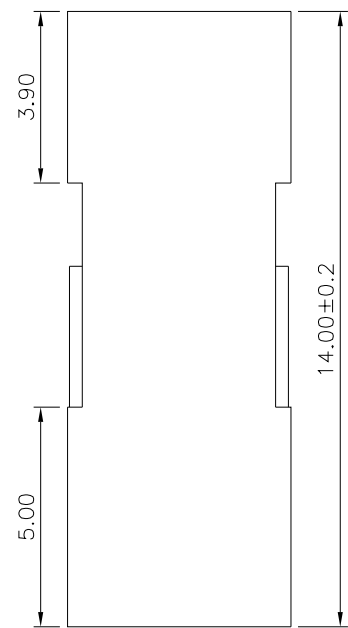
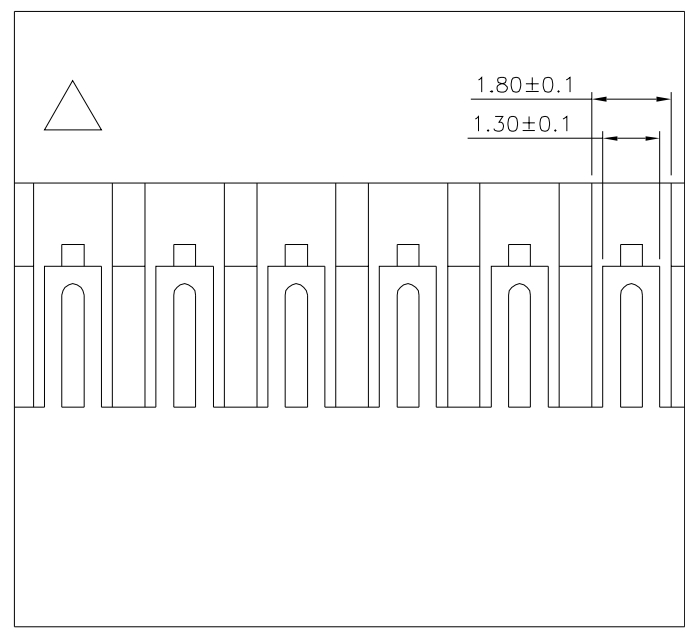
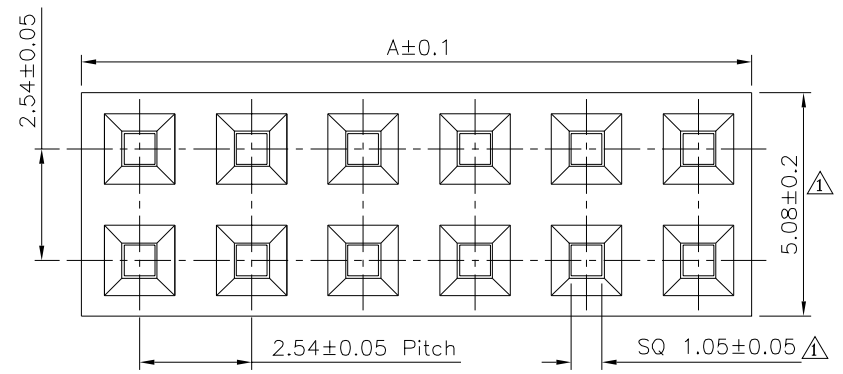

| Pin | A     |
|-----|-------|
| 04  | 5.08  |
| 06  | 7.62  |
| 08  | 10.16 |
| 10  | 12.7  |
| 12  | 15.24 |
| 14  | 17.78 |
| 16  | 20.32 |
| 18  | 22.86 |
| 20  | 25.4  |
| 22  | 27.94 |
| 24  | 30.48 |
| 26  | 33.02 |
| 28  | 35.56 |
| 30  | 38.10 |
| 32  | 40.64 |
| 34  | 43.18 |
| 36  | 45.72 |
| 38  | 48.26 |

**4UCON** 元化興業股份有限公司  
 4UCON TECHNOLOGY INC.

DRAWING No. **22199**  
 APPROVED BY MEI  
 CHECKED BY HZF  
 DRAWING BY CYP  
 SCALE NONE REV. A2

UNLESS OTHERWISE SPECIFIED  
 TOLERANCES ARE  
 .X ±0.1  
 .XX ±0.01  
 .XXX ±0.005  
 ANG. ±1°  
 UNIT mm

| NO. | REV. | REVISIONS   | CHK | DATE       |
|-----|------|-------------|-----|------------|
| △A2 |      | Modify Data | HZF | 07/09/2015 |
| △A1 |      | Modify Data | HZF | 10/07/2011 |
| △A0 |      | NEW RELEASE | HZF | 12/28/2010 |