

△ Recommended P.C.B. Layout (Top Side)  
(PCB Board Tolerance  $\pm 0.05$ )

**△ SPECIFICATION**  
 Current Rating: 3.0 Amp  
 Contact Resistance: 20 Milliohms Max.  
 Insulation Resistance: 1000 Megaohms Min.  
 Withstand Voltage: 1000V AC/DC  
 Operation Temperature:  $-40^{\circ}\text{C}$  To  $+105^{\circ}\text{C}$   
 Contact: Brass, Gold Plated Over Nickel  
 Insulator: PBT+30%G.F.(UL94V-0), Black  
 RoHS Compliant

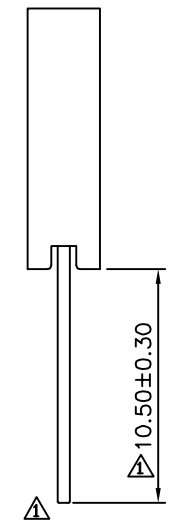
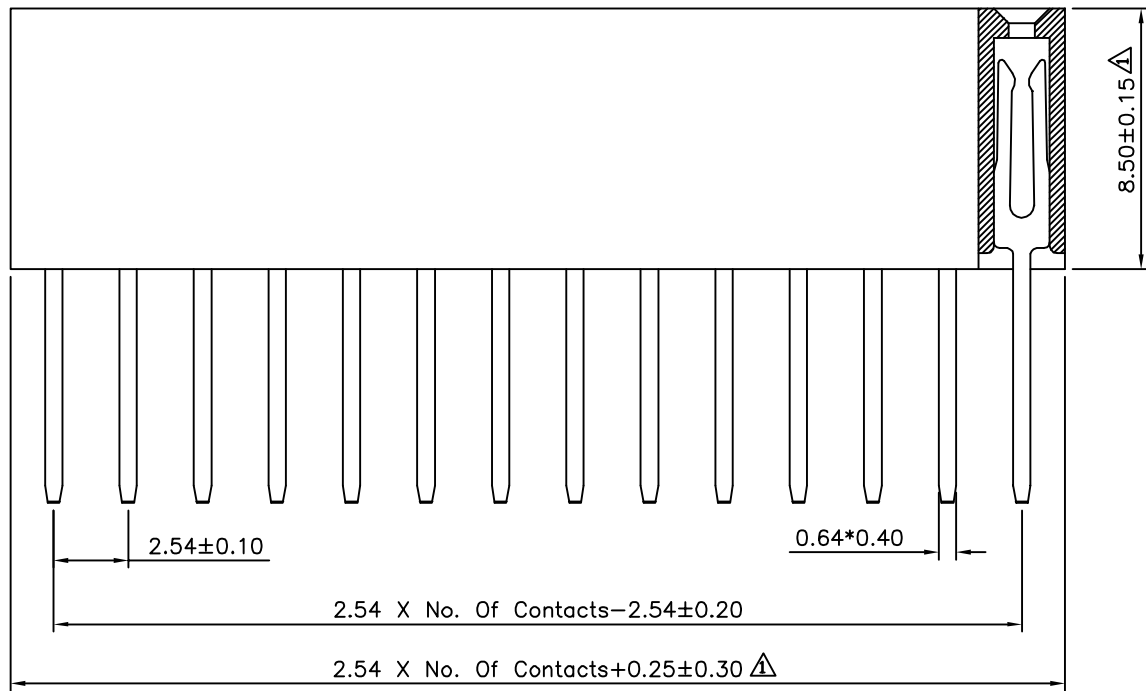
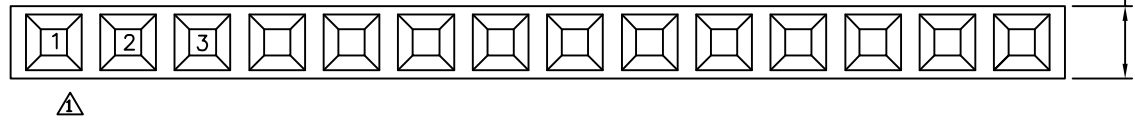

**4UCON** 元化興業股份有限公司  
 4UCON TECHNOLOGY INC.

DRAWING No.		APPROVED BY		UNLESS OTHERWISE SPECIFIED TOLERANCES ARE .X $\pm 0.40$ .XX $\pm 0.25$ .XXX $\pm 0.15$ ANG. $\pm 3^{\circ}$
20113		MEI		
		CHECKED BY HZF		
		DRAWING BY PEGA		
SCALE	NONE	REV.	A1	UNIT mm

NO.	REV.	REVISIONS	CHK	DATE
△ A1		Modify Data	HZF	04/02/2010
△ A0		NEW RELEASE	HZF	02/08/2007