

Recommended P.C.B. Layout(Top View)  
(PCB Board Tolerance±0.05)

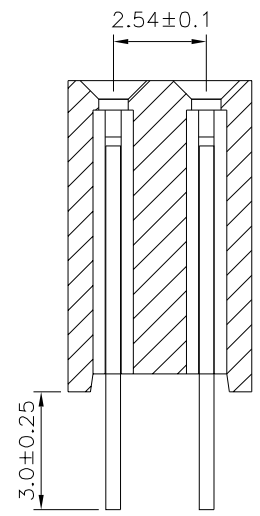
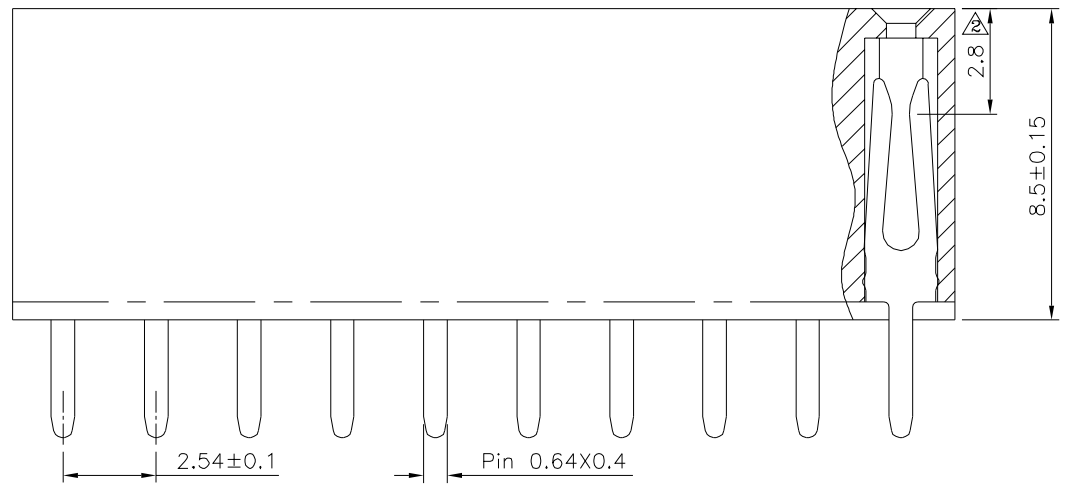
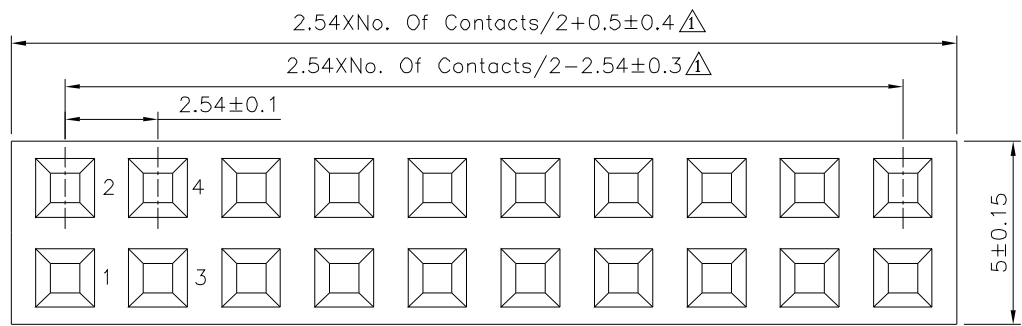

SPECIFICATION

- Current Rating:3A
- ② Withstand Voltage:1000V AC Min./Minute
- Contact Resistance:20 Milliohms Max.
- Insulation Resistance:1000 Megohms Min.
- Operation Temperature:-40°C~+105°C
- ③ Housing:PA9T(UL94V-0),Black
- Contact:Brass,Gold Flash Over Nickel
- RoHS Compliant

**4UCON** 元化興業股份有限公司  
4UCON TECHNOLOGY INC.

DRAWING No.		APPROVED BY		UNLESS OTHERWISE SPECIFIED TOLERANCES ARE X. ±0.25 X.* ±2" .X ±0.20 X.* ±1.5" .XX ±0.15 .XX* ±1" .XXX ±0.10 .XXX* ±0.5"	NO.	REV.	REVISIONS	CHK	DATE
18158		EMILY							
SCALE NONE		HZF							
REV.		SAN		UNIT mm		A3			

③	A3	Modify Data	HZF	05/16/2024
②	A2	Modify Data	HZF	11/06/2021
①	A1	Modify Data	HZF	05/28/2014
④	A0	NEW RELEASE	HZF	04/08/2013