

Recommended P.C.B. Layout (Top View)
(PCB Board Tolerance ±0.05)

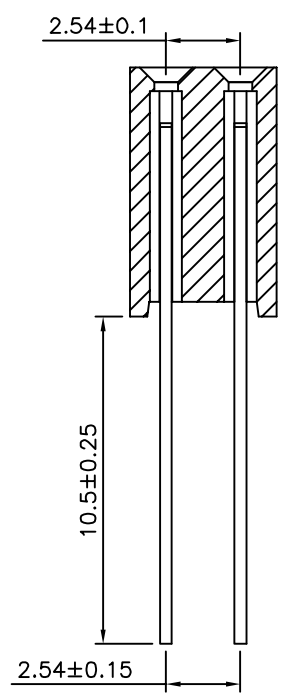
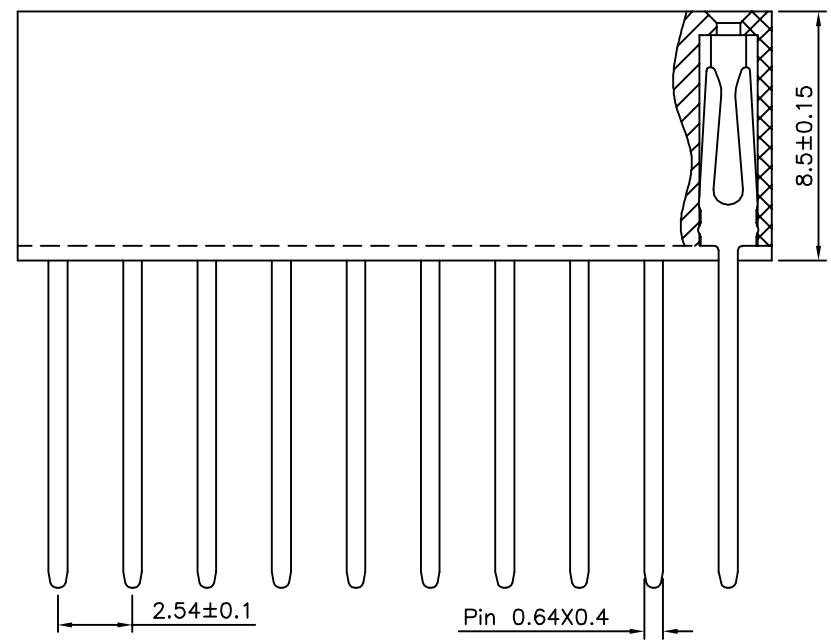
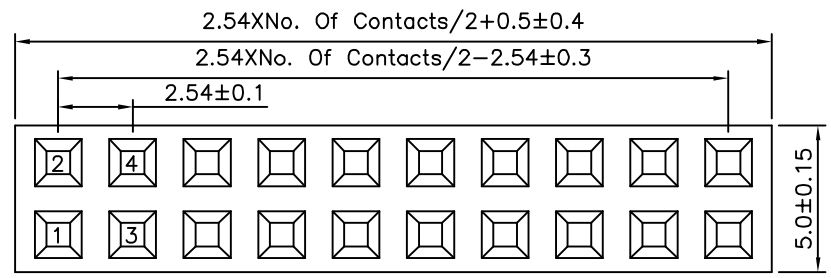

SPECIFICATION

Current Rating: 3A
 Withstand Voltage: 1000V AC
 Contact Resistance: 20 Milliohms Max.
 Insulation Resistance: 1000 Megohms Min.
 Operating Temperature: -40°C ~ +105°C
 Insulator: PA6T(UL94V-0), Black
 Contact: Brass, Gold Flash Over Nickel
 RoHS Compliant

4UCON 元化興業股份有限公司
 4UCON TECHNOLOGY INC.

DRAWING No.		APPROVED BY		UNLESS OTHERWISE SPECIFIED TOLERANCES ARE
11261		EMILY		
		CHECKED BY		
		HZF		
		DRAWING BY		X ±0.25 X' ±2°
		HAO		.X ±0.20 .X' ±1.5°
				.XX ±0.15 .XX' ±1°
				.XXX ±0.10 .XXX' ±0.5°
SCALE	NONE	REV.	A0	UNIT mm
				⊕

NO.	REV.	REVISIONS	CHK	DATE
△ A0		NEW RELEASE	HZF	02/06/2015