

△ SPECIFICATION
 Current Rating: 3A AC/DC
 Voltage Rating: 250V AC Max.
 Operation Temperature: -25°C~+85°C
 Contact Resistance: 10 Milliohms Max.
 Insulation Resistance: 1000 Megaohms Min.
 Withstanding Voltage: 1000V AC/Minute
 Contact: Brass, Tin Plated
 Insulator: PA66(UL94V-0), Nature
 RoHS Compliant

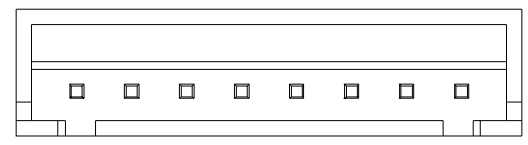

△△

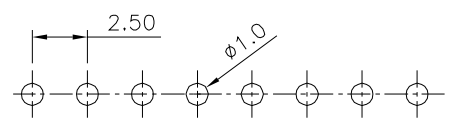

Recommended P.C.B. Layout

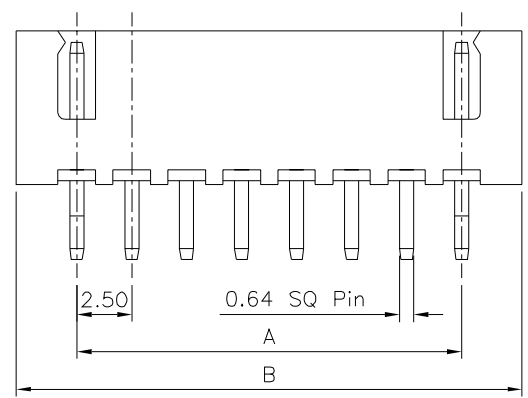

△△ 3~12 Pin

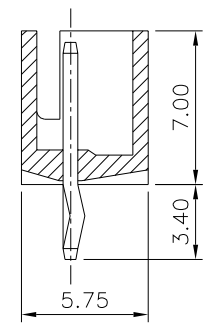

△

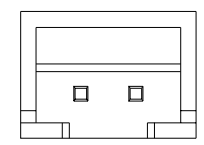

△△

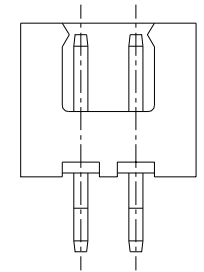

△△ 2 Pin

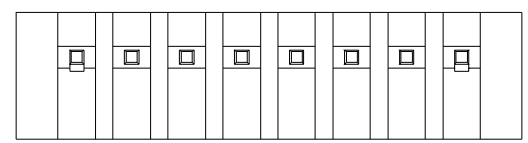

△

△△

| Pin | A | B |
|-----|-------|-------|
| 02 | 2.50 | 7.50 |
| 03 | 5.00 | 10.00 |
| 04 | 7.50 | 12.50 |
| 05 | 10.00 | 15.00 |
| 06 | 12.50 | 17.50 |
| 07 | 15.00 | 20.00 |
| 08 | 17.50 | 22.50 |
| 09 | 20.00 | 25.00 |
| 10 | 22.50 | 27.50 |
| 11 | 25.00 | 30.00 |
| 12 | 27.50 | 32.50 |
| 13 | 30.00 | 35.00 |
| 14 | 32.50 | 37.50 |
| 15 | 35.00 | 40.00 |
| 16 | 37.50 | 42.50 |
| 20 | 47.50 | 52.50 |

4UCON

元化興業股份有限公司
 4UCON TECHNOLOGY INC.

| | | | | |
|-------------|------|-------------|-----|--|
| DRAWING No. | | APPROVED BY | | UNLESS OTHERWISE SPECIFIED TOLERANCES ARE .X ±0.35 .XX ±0.25 |
| 01612 | | MEI | | |
| | | CHECKED BY | HZF | |
| | | DRAWING BY | HAO | |
| SCALE | NONE | REV. | A2 | UNIT mm |

| NO. | REV. | REVISIONS | CHK | DATE |
|-----|------|-------------|-----|------------|
| 3 | A3 | Modify Data | HZF | 03/03/2016 |
| 2 | A2 | Modify Data | HZF | 03/17/2015 |
| 1 | A1 | Modify Data | HZF | 02/23/2011 |
| 0 | A0 | NEW RELEASE | HZF | 08/24/2009 |