

△ SPECIFICATION
 Current Rating: 3A AC/DC
 Voltage Rating: 250V AC Max.
 Operation Temperature: -25°C~+85°C
 Contact Resistance: 10 Milliohms Max.
 Insulation Resistance: 1000 Megaohms Min.
 Withstanding Voltage: 1000V AC/Minute
 Contact: Brass, Tin Plated
 Insulator: PA66(UL94V-0), Nature
 RoHS Compliant

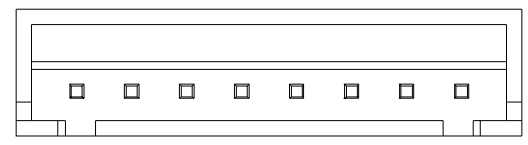

△△

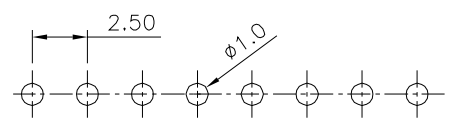

Recommended P.C.B. Layout

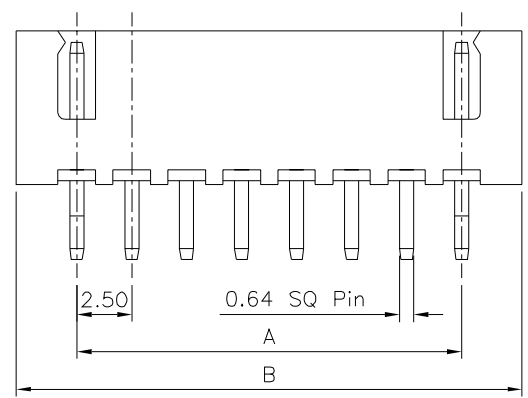

△△ 3~12 Pin

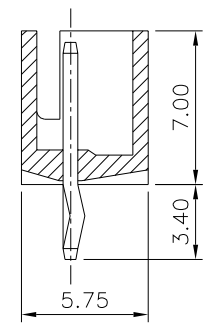

△

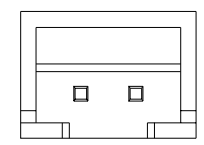

△△

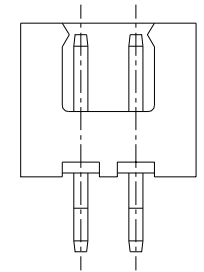

△△ 2 Pin

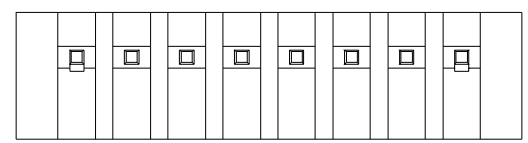

△

△△

Pin	A	B
02	2.50	7.50
03	5.00	10.00
04	7.50	12.50
05	10.00	15.00
06	12.50	17.50
07	15.00	20.00
08	17.50	22.50
09	20.00	25.00
10	22.50	27.50
11	25.00	30.00
12	27.50	32.50
13	30.00	35.00
14	32.50	37.50
15	35.00	40.00
16	37.50	42.50
20	47.50	52.50

4UCON 元化興業股份有限公司
 4UCON TECHNOLOGY INC.

DRAWING No.		APPROVED BY		UNLESS OTHERWISE SPECIFIED TOLERANCES ARE .X ±0.35 .XX ±0.25
01611		MEI		
		CHECKED BY	HZF	
		DRAWING BY	HAO	
SCALE	NONE	REV.	A2	UNIT mm

NO.	REV.	REVISIONS	CHK	DATE
3	A3	Modify Data	HZF	03/03/2016
2	A2	Modify Data	HZF	03/17/2015
1	A1	Modify Data	HZF	02/23/2011
0	A0	NEW RELEASE	HZF	08/24/2009