

SPECIFICATION

Current Rating:1A Max.
 Operation Voltage:150V AC Max.
 Withstand Voltage:500V AC RMS
 Contact Resistance:20 Milliohms Max.
 Insulation Resistance:500 Megaohms Min.
 Operation Temperature:-40°C~+85°C
 Insulator:PA9T(UL94V-0),Nature
 ⚠ Contact:Brass,Bright Tin Plated Over Nickel
 ⚠ Locating:Brass,Bright Tin Plated Over Nickel
 RoHS Compliant

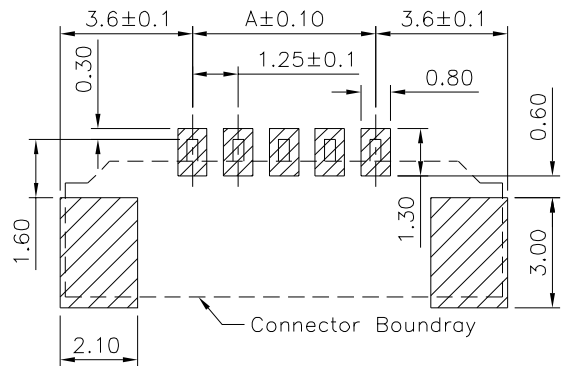

Recommended P.C.B. Layout

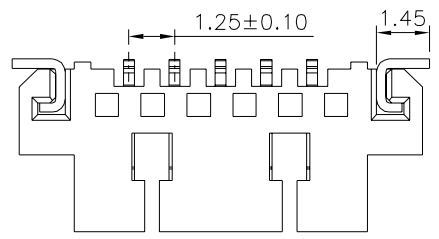
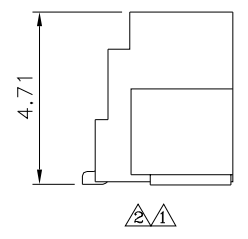
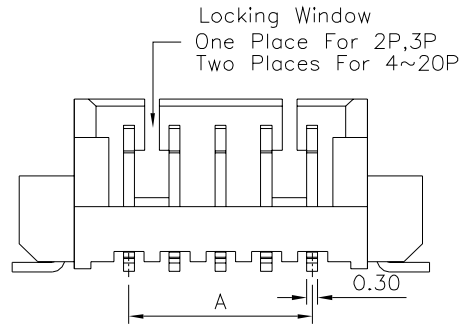
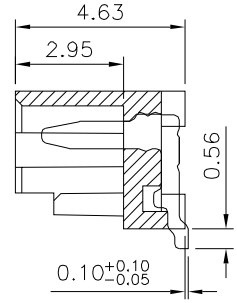
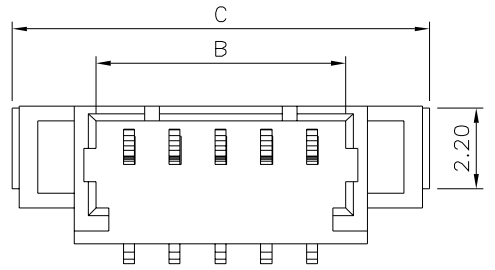

Pin	A	B	C
2	1.25	3.05	7.65
3	2.50	4.30	8.90
4	3.75	5.55	10.15
5	5.00	6.80	11.40
6	6.25	8.05	12.65
7	7.50	9.30	13.90
8	8.75	10.55	15.15
9	10.00	11.80	16.40
10	11.25	13.05	17.65
11	12.50	14.30	18.90
12	13.75	15.55	20.15
13	15.00	16.80	21.40
14	16.25	18.05	22.65
15	17.50	19.30	23.90
16	18.75	20.55	25.15
17	20.00	21.80	26.40
18	21.25	23.05	27.65
19	22.50	24.30	28.90
20	23.75	25.55	30.15

4UCON 元化興業股份有限公司
 4UCON TECHNOLOGY INC.

DRAWING No.		APPROVED BY		UNLESS OTHERWISE SPECIFIED TOLERANCES ARE .X ±0.30 .XX ±0.20 ANG.
01229		MEI		
		CHECKED BY HZF		
SCALE NONE		DRAWING BY CYP		
REV.	A2	UNIT mm		

NO.	REV.	REVISIONS	CHK	DATE
⚠	A2	Modify Data	HZF	03/28/2017
⚠	A1	Modify Data	HZF	02/20/2013
⚠	A0	NEW RELEASE	HZF	05/07/2012