

Recommended P.C.B. Layout (Top View)  
(PCB Board Tolerance  $\pm 0.05$ )

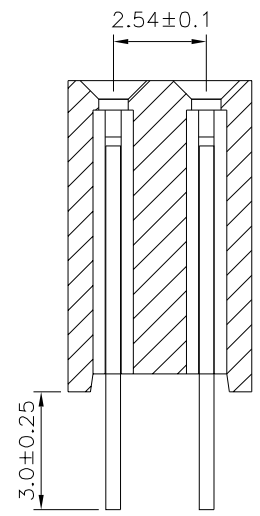
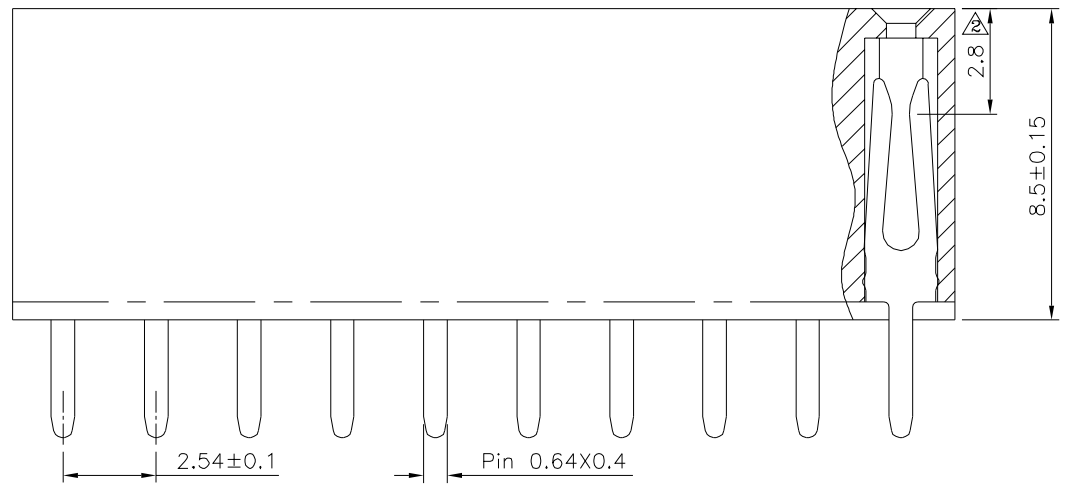
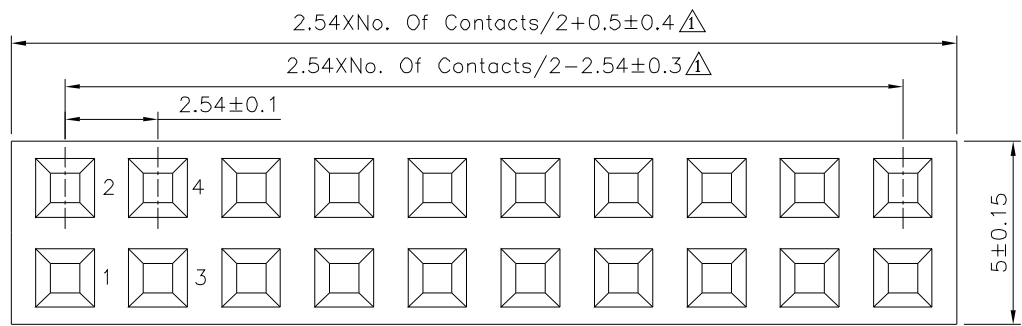

SPECIFICATION

- Current Rating: 3A
- Withstand Voltage: 1000V AC Min./Minute
- Contact Resistance: 20 Milliohms Max.
- Insulation Resistance: 1000 Megohms Min.
- Operation Temperature:  $-40^{\circ}\text{C} \sim +105^{\circ}\text{C}$
- Housing: PA9T (UL94V-0), Black
- Contact: Brass, Gold Flash Over Nickel
- RoHS Compliant

**4UCON** 元化興業股份有限公司  
4UCON TECHNOLOGY INC.

DRAWING No.		APPROVED BY		UNLESS OTHERWISE SPECIFIED TOLERANCES ARE X. $\pm 0.25$ X.* $\pm 2^{\circ}$ .X $\pm 0.20$ .X* $\pm 1.5^{\circ}$ .XX $\pm 0.15$ .XX* $\pm 1^{\circ}$ .XXX $\pm 0.10$ .XXX* $\pm 0.5^{\circ}$	NO. REV.	REVISIONS	CHK	DATE				
00571		EMILY							③ A3	Modify Data	HZF	05/16/2024
		CHECKED BY							② A2	Modify Data	HZF	11/06/2021
		DRAWING BY		① A1	Modify Data	HZF	05/28/2014					
SCALE	NONE	REV.	A3	UNIT								
				mm								

