

Recommended PCB Layout

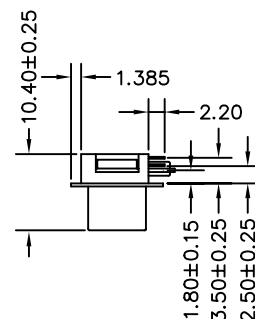

SPECIFICATIONS

Rated current:5A
 Rated Voltage:300V DC
 Withstanding Voltage:500V rms For 1 Minute
 Insulation Resistance:More Than 1000Megohms at 500V DC
 Contact Resistance:13 Milliohms Max
 Dielectric Strength:1000V AC Min for 1 minute
 Temperature:-55 °C~+105 °C
 Shell -Steel zinc plated or tin plated
 Bracket-Brass strip-H nickel plated
 Screw-Brass nickel plated
 Insulator-PBT With glass fiber reinforced
 UL-94V0,color black
 Contact: Phosphor Bronze
 Duplex plated as follows:
 15u",30u"Gold On Mating End
 tin-lead on termination end, with entire contact nickel
 Gold flash on mating end.
 tin-lead on termination end, with entire contact nickel

4UCON 元化興業股份有限公司
 4UCON TECHNOLOGY INC.

DRAWING No.
 09782

APPROVED BY MEI
 CHECKED BY RAN
 DRAWING BY HZF
 REV. A0

UNLESS OTHERWISE SPECIFIED
 TOLERANCES ARE
 .X ±0.25
 .XX ±0.15
 .XXX ±0.08

SCALE NONE

UNIT mm

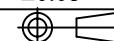

AREA REVISIONS CHK DATE