

(.XX ±0.05 For PCB)
Reference PCB Layout

SPECIFICATIONS

1. General Information
 - . Contact Principle: Friction Technology
 - . Mounting Type: SMT
 - . Data Contact Material: Copper Alloy
 - . Insulator Material: Thermoplastic UL94V-0
 - . Data Contacts Plating: Gold Plated Over Nickel
 2. Electrical Specification
 - . Contact Resistance: 50m Ohms Max
 - . Insulator Resistance: 1000M Ohms Min
 - . Dielectric Withstanding Voltage: 500V AC
 - . Voltage Rating: 30V AC R.M.S. 1 Min(Sea Level)
 - . Current Rating: 1A Max, 10uA Min
 3. Mechanical Specification
 - . Contact Force: 0.2N~0.6N
 - . Durability: 10,000 Cycles Min
 4. Environmental Specification
 - . Operating Temperature: -20°C~+70°C
 - . Operating Humidity: 20%~95% RH
 - . Solderability: Manual Soldering: 360°C, 3 Sec Max
Vapor Phase: 215°C, 30 Sec Max
IR Re-flow : 260°C, 15 Sec Max
- .RoHS Compliant

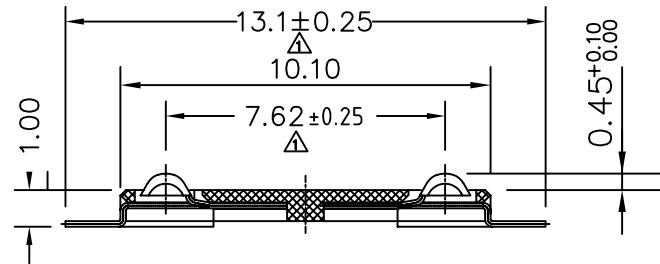
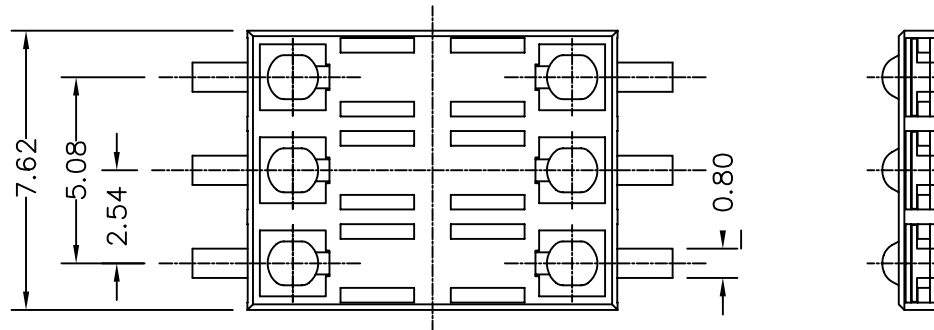

4UCON 元化興業股份有限公司
4UCON TECHNOLOGY INC.

DRAWING No.

08964

APPROVED BY

MEI

CHECKED BY

LHC

DRAWING BY

KENVIN 04/02/2008

REV.

A1

UNLESS OTHERWISE SPECIFIED TOLERANCES ARE

.X ±0.25

.XX ±0.10

ANG. ±1°

UNIT

mm

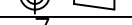
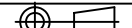

1	A1	MODIFIED TOLERANCE	KENVIN	04/02/2008
0	A0	NEW RELEASE	XSH	05/18/2007
NO. REV.		REVISIONS	CHK	DATE