

△△ SPECIFICATION
 Current:7.0A Max.
 Voltage:250V Max.
 Withstanding Voltage:1500V
 Insulation Resistance:500K Megaohms Min.
 Temperature Range:-40°C~+105°C
 △△ Housing:PA66(UL94V-2),White
 △△ Contact:Brass,Tin Plated Over Nickel
 RoHS Compliant

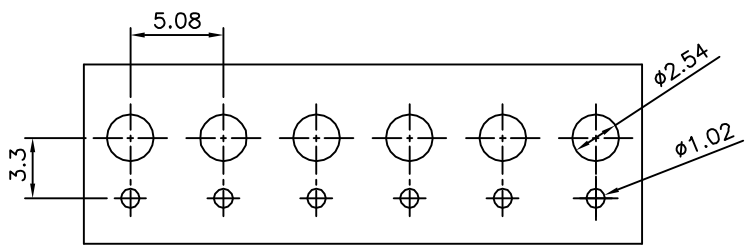

Recommended P.C.B. Layout

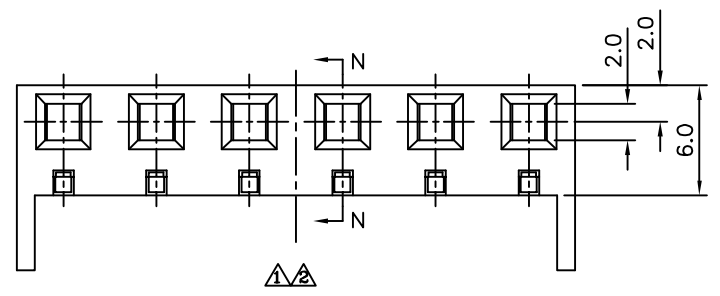

△△

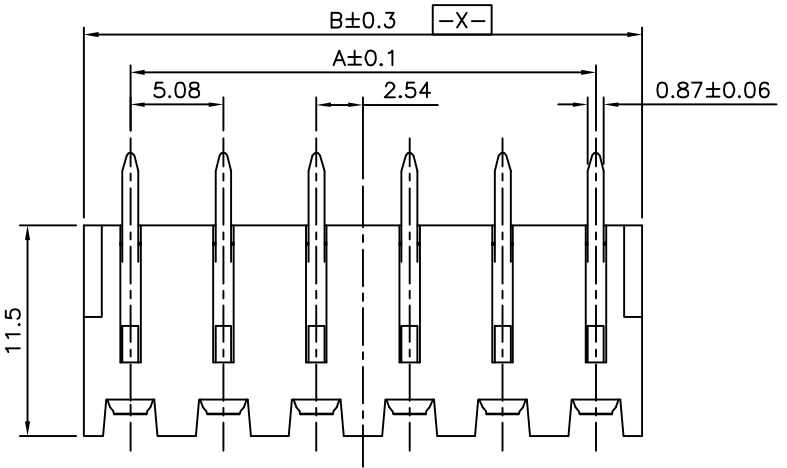

△△

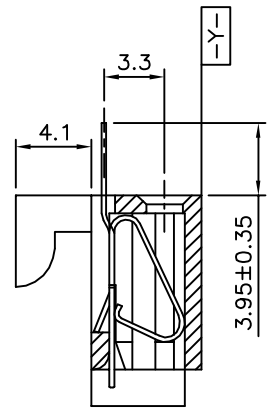

△△ Section:N-N

Circuit	A	B
2	5.08	10.16
3	10.16	15.24
4	15.24	20.32
5	20.32	25.40
6	25.40	30.48
7	30.48	35.56
8	35.56	40.64
9	40.64	45.72
10	45.72	50.80
11	50.80	55.88
12	55.88	60.96

4UCON 元化興業股份有限公司
 4UCON TECHNOLOGY INC.

DRAWING No. 14930

APPROVED BY MEI
 CHECKED BY HZF
 DRAWING BY HAO

UNLESS OTHERWISE SPECIFIED TOLERANCES ARE
 △.X ±0.30 X.* ±1*
 .XX ±0.20 .X.* ±0.5*
 .XXX ±0.10 .XX.* ±0.25*

SCALE	NONE	REV.	A3	UNIT	mm	NO. REV.	REVISIONS	CHK	DATE

NO.	REV.	REVISIONS	CHK	DATE
△A3		Modify Data	HZF	05/20/2015
△A2		Modify Data	HZF	06/01/2012
△A1		Modify Data	HZF	05/26/2010
△A0		NEW RELEASE	BECKY	2004/06/07