

SPECIFICATION

Current Rating:1 Amps
 Withstand Voltage:500V For 1 Minute
 Contact Resistance:30 Milliohms Max.
 Insulation Resistance:1000 Megaohms Min.
 At 500V DC
 Operation Temperature:-55°C~+105°C
 Insulator:PBT+30%G.F.(UL94V-0),White
 Contact:Brass,Gold Flash Over Nickel
 Shell:Steel,Front:Nickel Plated,Rear:Tin Plated
 Boardlocks:Brass,Tin Plated
 RoHS Compliant

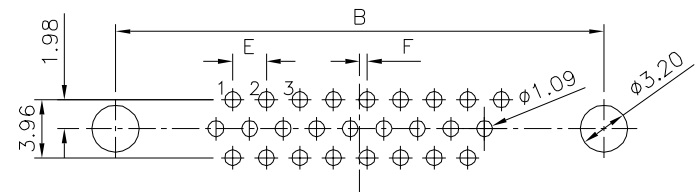

Recommended P.C.B. Layout(26,44,62 Pin)

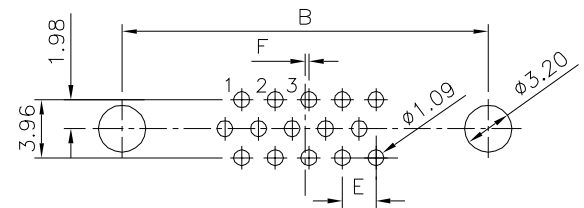

Recommended P.C.B. Layout(15 Pin)

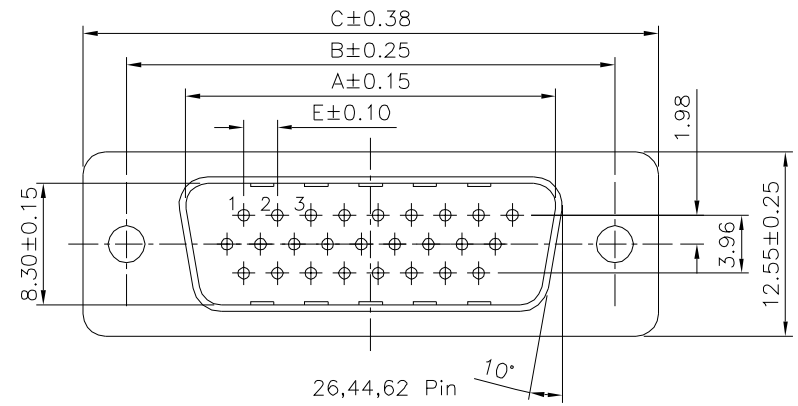

26,44,62 Pin

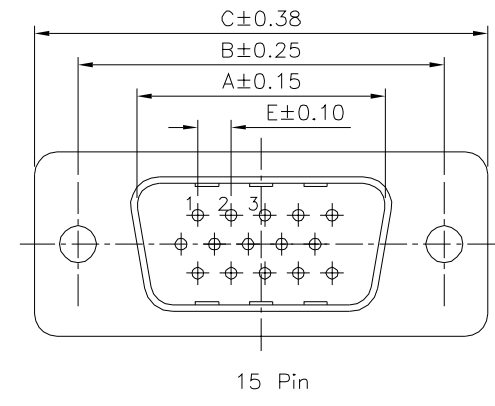

15 Pin

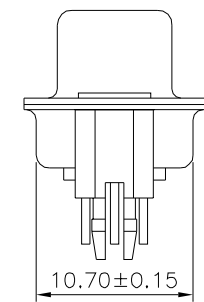
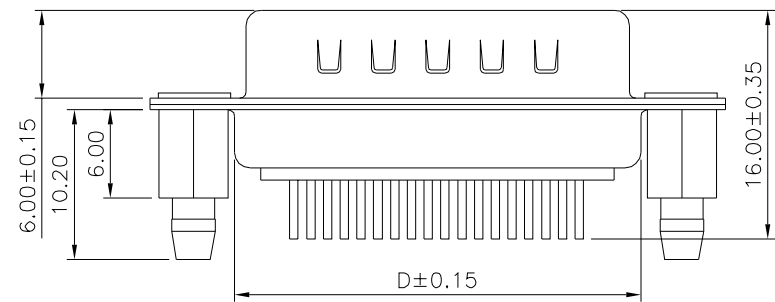

| Position | A | B | C | D | E | F |
|----------|-------|-------|-------|-------|------|------|
| 15 | 16.92 | 24.99 | 30.81 | 19.20 | 2.29 | 0.25 |
| 26 | 25.25 | 33.32 | 39.20 | 27.70 | 2.29 | 0.50 |
| 44 | 38.96 | 47.04 | 53.04 | 41.10 | 2.29 | 0.50 |
| 62 | 55.42 | 63.50 | 69.40 | 57.30 | 2.41 | 0.60 |

4UCON 元化興業股份有限公司
 4UCON TECHNOLOGY INC.

| | | | | |
|-------------|------|-------------|-----|---|
| DRAWING No. | | APPROVED BY | | UNLESS OTHERWISE SPECIFIED TOLERANCES ARE .X ±0.25 .X* ±3* .XX ±0.25 .XX* ±1* .XXX ±0.05 .XXX* ±0.5* |
| 02702 | | MEI | | |
| | | CHECKED BY | HZF | |
| | | DRAWING BY | CYP | |
| SCALE | NONE | REV. | A0 | UNIT mm |

| | | | | |
|-----|------|-------------|-----|------------|
| NO. | REV. | REVISIONS | CHK | DATE |
| △ | A0 | NEW RELEASE | HZF | 06/10/2020 |