

Recommended P.C.B. Layout (Top View)
(PCB Board Tolerance ± 0.05)

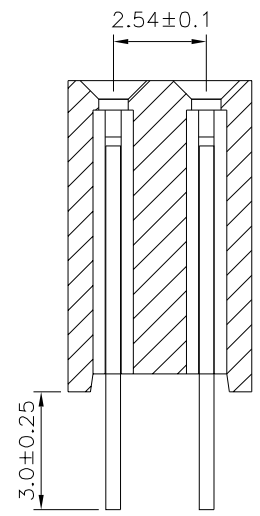
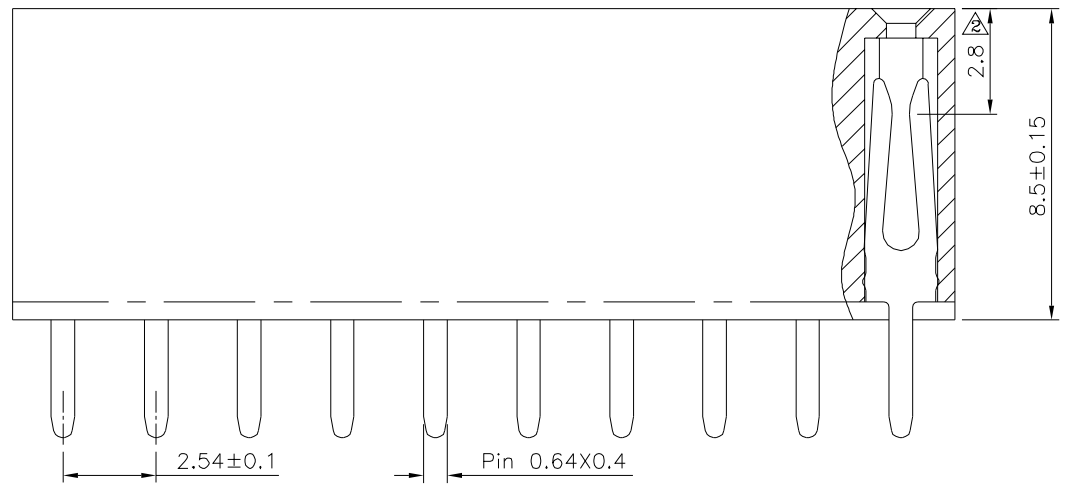
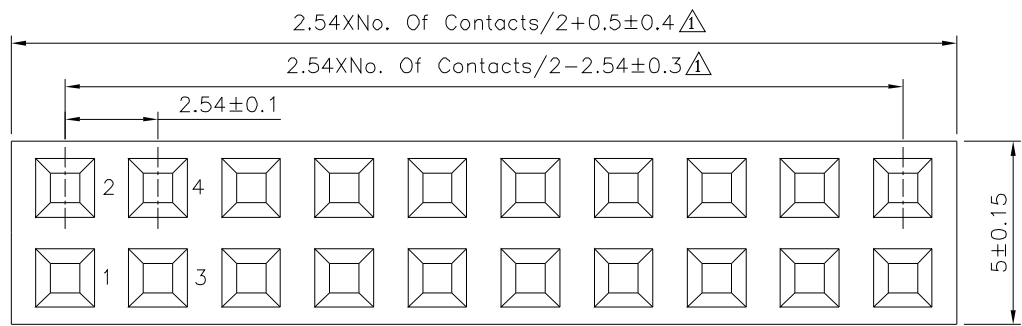

SPECIFICATION

- Current Rating: 3A
- Withstand Voltage: 1000V AC Min./Minute
- Contact Resistance: 20 Milliohms Max.
- Insulation Resistance: 1000 Megohms Min.
- Operation Temperature: $-40^{\circ}\text{C} \sim +105^{\circ}\text{C}$
- Housing: PA9T (UL94V-0), Black
- Contact: Brass, Gold Flash Over Nickel
- RoHS Compliant

4UCON 元化興業股份有限公司
4UCON TECHNOLOGY INC.

DRAWING No.		APPROVED BY		UNLESS OTHERWISE SPECIFIED TOLERANCES ARE X. ± 0.25 X.* $\pm 2^{\circ}$.X ± 0.20 .X* $\pm 1.5^{\circ}$.XX ± 0.15 .XX* $\pm 1^{\circ}$.XXX ± 0.10 .XXX* $\pm 0.5^{\circ}$
00593		EMILY		
		CHECKED BY HZF		
DRAWING BY SAN		UNIT mm		NO. REV. REVISIONS
SCALE	NONE	REV.	A3	

③ A3	Modify Data	HZF	05/16/2024
② A2	Modify Data	HZF	11/06/2021
① A1	Modify Data	HZF	05/28/2014
④ A0	NEW RELEASE	HZF	04/08/2013